

THIS SHEET INCLUDES FITTING INSTRUCTIONS FOR THE FOLLOWING PARTS:

Secondary Alternator Cover Part No. EC-CBR500-2013-1-GBR

Secondary Clutch Cover Part No. EC-CBR500-2013-2-GBR

Secondary Pulse Cover Part No. EC-CBR500-2013-3-GBR



SECONDARY ALTERNATOR COVER PART NO. EC-CBR500-2013-1-GBR

- 1 Remove 2 existing bolts from the sprocket cover as shown in FIG. 1 to allow you to move the cover away and gain access to the Alternator bolts behind.
- 2 Remove 4 existing bolts from the stock Alternator Cover as shown in FIG. 2. Ensure correct bolt is removed as shown in FIG. 3.
- 3 Place the Secondary Alternator Cover over the stock cover.
- 4 Assemble 4 replacement bolts loosely in the correct position as shown.
- 5 Tighten bolts to a Torque of 10Nm as per Manufacturer's recommendations. **DO NOT OVERTIGHTEN**
- 6 Refit the sprocket cover using the 2 existing bolts and tighten as shown in FIG. 1.

Bolt 4
M6x40 - 10Nm

Bolt 1
M6x40 - 10Nm

Bolt 3
M6x40 - 10Nm

Bolt 2
M6x40 - 10Nm

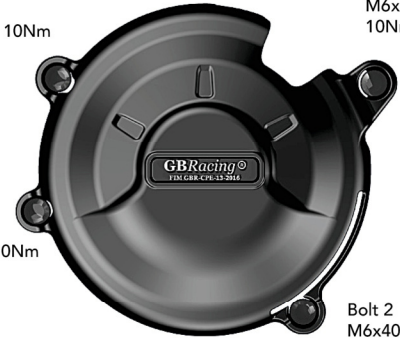

FIG. 1

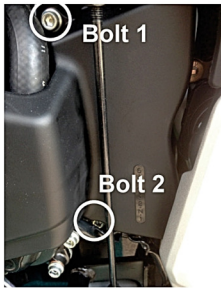

FIG. 2

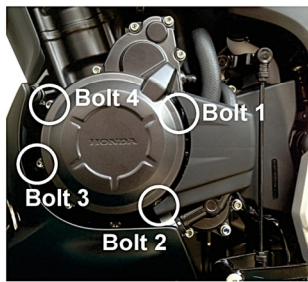
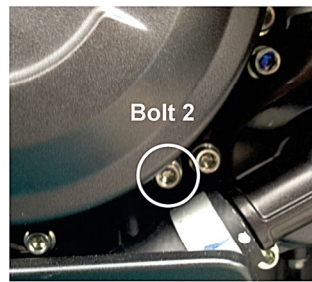

FIG. 3



SECONDARY CLUTCH COVER PART NO. EC-CBR500-2013-2-GBR

- 1 Remove 4 existing bolts from the stock Clutch Cover as shown in FIG. 1.
- 2 Place the Secondary Clutch Cover over the stock cover and ensure that the clutch cable bracket is still in its correct position and mounted on the locating pin as shown in FIG. 2.
- 3 Assemble 4 replacement bolts loosely in the correct position as shown.
- 4 Tighten bolts to a Torque of 10Nm as per Manufacturer's recommendations. **DO NOT OVERTIGHTEN**

Bolt 1
M6x40 - 10Nm

Bolt 2
M6x40 - 10Nm

Bolt 4
M6x40 - 10Nm

Bolt 3
M6x40 - 10Nm

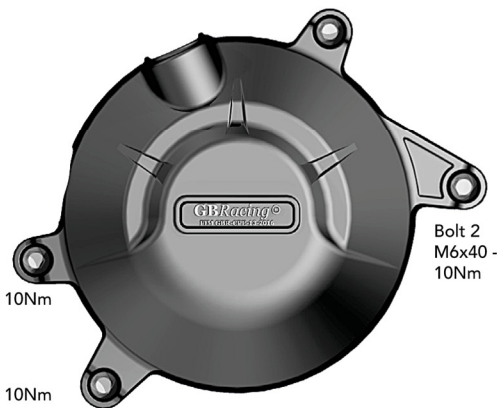

FIG. 1

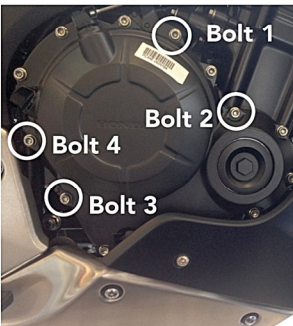

FIG. 2



SECONDARY PULSE COVER PART NO. EC-CBR500-2013-3-GBR

- 1 Remove fairing bolt as shown in FIG.1 to enable you to move the fairing out of the way to gain access to the stock bolts.
- 2 Remove 3 existing bolts from the stock Pulse cover, shown as position Bolt 1, 2, & 3 (FIG. 2).
- 3 Place the Secondary Pulse Cover over the stock cover.
- 4 Assemble the 3 replacement bolts loosely in the correct position as shown.
- 5 Tighten bolts to a Torque of 10Nm as per manufacturers recommendations.
- 6 Replace fairing bolt and tighten.

